

DRS

Vacuum System for Site Clean - Exploded View (1015.03.040)

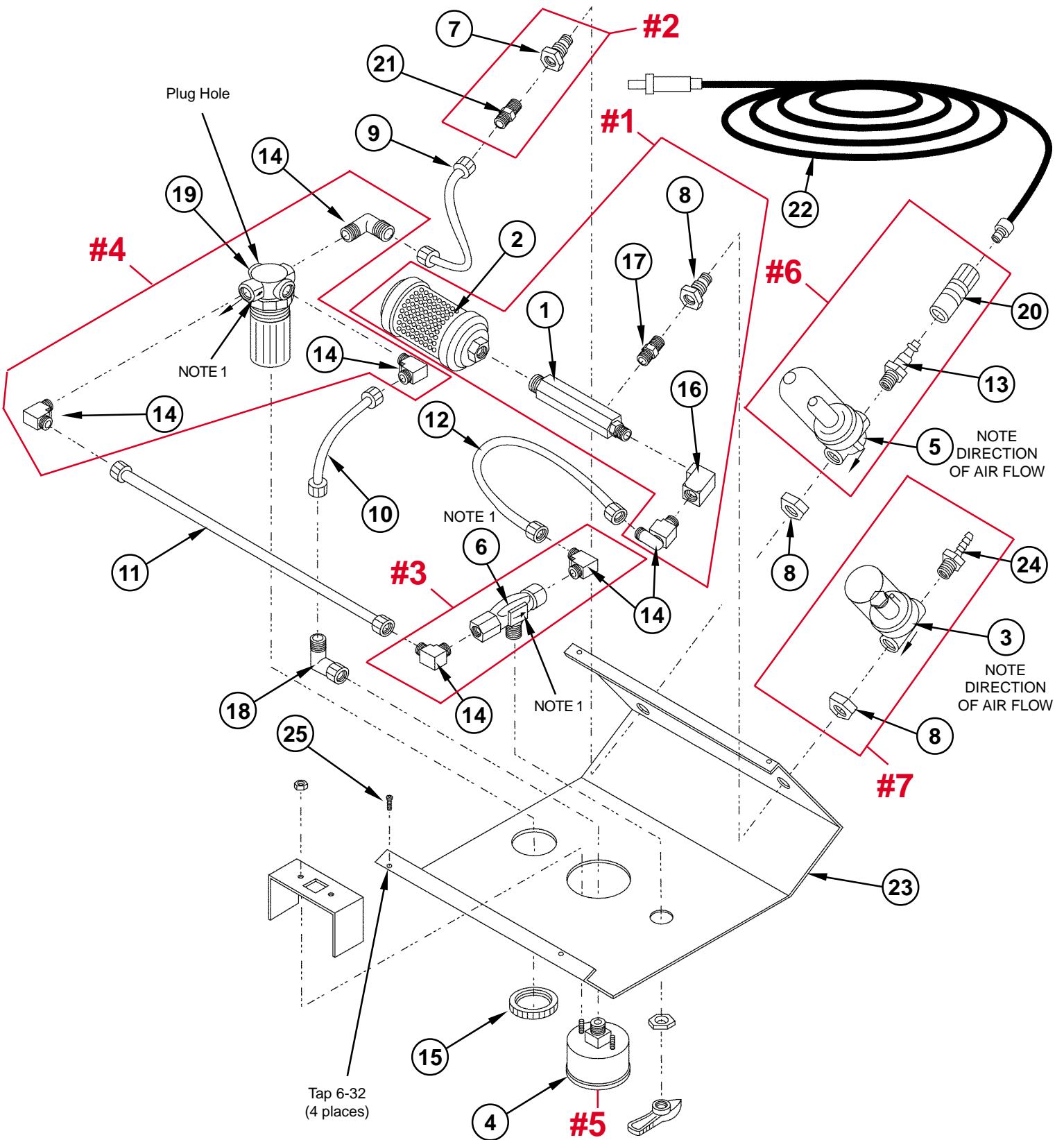

DRS**Vacuum System for Site Clean - Parts List (1015.03.040)**

	<u>Description</u>	<u>Qty.</u>	<u>Location</u>	<u>Part Number</u>
1.	Vacuum Pump	1	2B102	HAV147H
2.	Muffler, S1FZ	1	5D81	S147AV
3.	F1A Vacuum Filter	1	5D14	F1A
4.	Pressure Gauge, 0-100 (panel mount)	1	10A3	9001.12.014
5.	Airline Filter	1	10A4	9001.12.015
6.	On/Off Valve	1	10A2	9001.12.016
7.	Bulkhead Fitting	2	11A58	12710
8.	Nut	2	11A57	12710-1
9.	Polyflow Tubing	3"	11E9	12755
10.	Polyflow Tubing	10"	11E9	12755
11.	Polyflow Tubing	3 3/4"	11E9	12755
12.	Polyflow Tubing	13 1/2"	11E9	12755
13.	Male Disconnect	1	12E143	9001.08.000
14.	1/8" Male 90 degree Poly NPT	6	12E149	9001.00.027
15.	Panel Nut, Pressure Regulator	1	12E173	12758
16.	1/8" x 1/8" Female 90 degree NPT Union	1	16D105	9001.00.060
17.	1/8" x 1/8" Male NPT Hex	1	16D80	TC3-23
18.	1/8" NPTF, 90 degree Poly	1	16D103	9001.00.040
19.	Pressure Regulator (panel mount)	1	16C105	TC3-04
20.	Female Disconnect	1	17B95	9001.00.048
21.	1/8" Male Straight Poly NPT	1	16D102	9001.00.037
22.	Hose Assembly	1	7A1	TC3-29
23.	Metal Box	1	10C019	1015.03.101
24.	1/8" NPT x 3/16" Barb	1	17A97	9001.00.049
25.	6-32 x 1/4" Button Head screws	4	1B	1B

NOTES: Refer To Drawing

- 1. Orient valve with air flow facing as shown in drawing.*
- 2. Set regulator to 60 psi.*
- 3. Test for On/Off and air leaks.*
- 4. Label face panel.*
- 5. Assemble cover and place 4 rubber feet on bottom.*

DRS Vacuum System for Site Clean - Assembled View

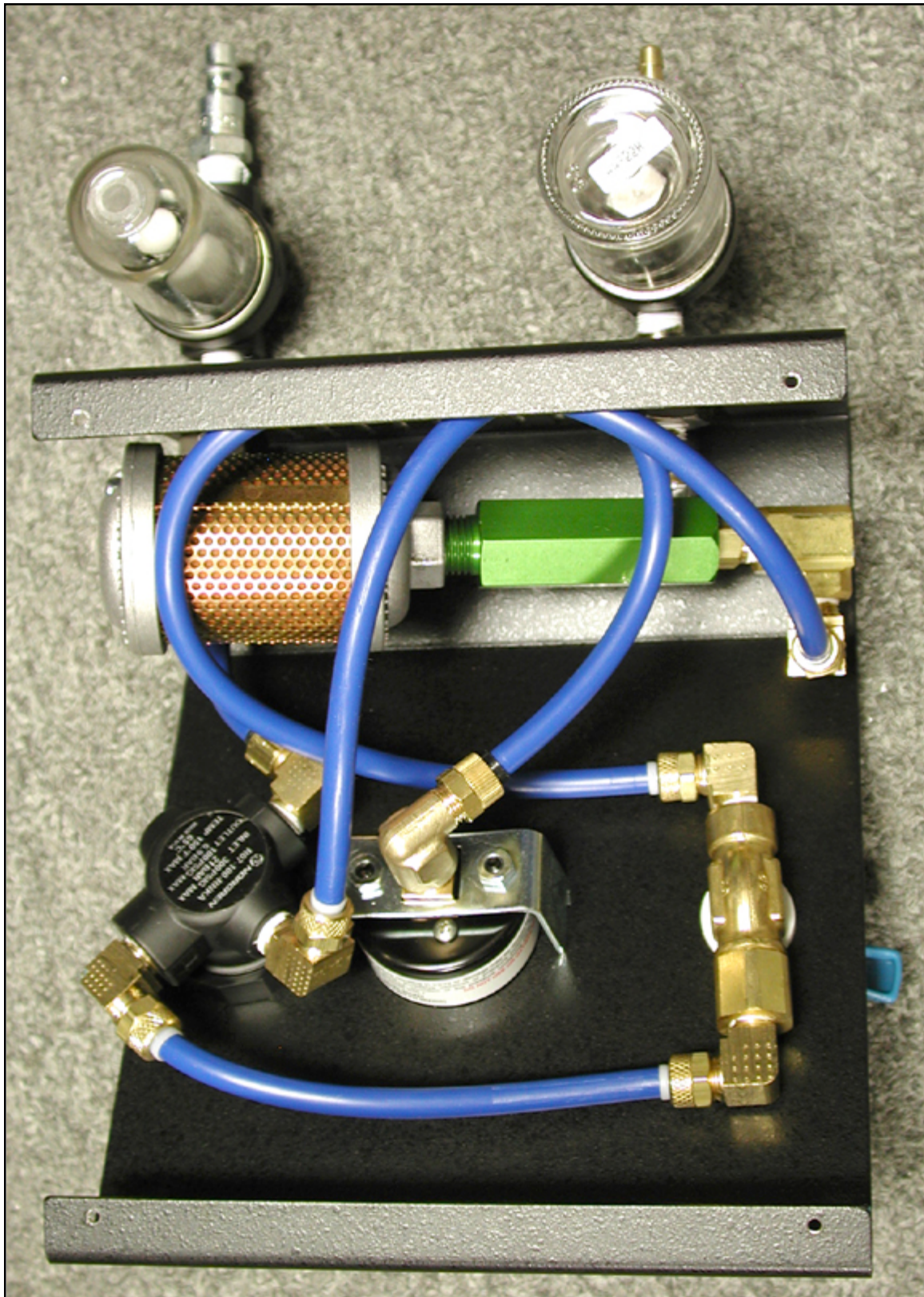

DRS

Vacuum System for Site Clean - Label Placement

